

## THE BEST-SELLING BLINDS BETWEEN GLASS Now Available for Entry Doors

### Light and Privacy Control

The perfect levels of light and privacy are yours to control. Our superior **EasyGlide System** allows our blinds to tilt completely closed, keeping you safe from prying eyes and unwanted light.

### Easy to Operate

The ergonomically placed operator lets you raise, lower and tilt your blinds the entire length of the doorglass with only the slightest movement. No reaching or stooping is needed to adjust the blinds.

### Low Maintenance

Since our blinds are enclosed between two panels of glass, you never need to dust which decreases allergens in your home. Blink Entry Doorglass carries a 20-year warranty on blinds, glass seal and operator for a long-term performance in your exterior door.

### Safety

With no dangling cords, Blink Entry Doorglass is certified safe for children and pets. All of our enclosed blinds are offered in tempered safety glass.



### Attention to Detail

We prioritized style and design by offering several colors and paid attention to aesthetic details, such as covering the cords with a bottom rail and matching all the visible components. Choose from an Evolve® or ZEEL® doorglass frame, and clear or Low-E glass.



### Sizes

|              |   |
|--------------|---|
| IG Thickness | 1"  |
| Doorglass    | 20 x 36, 22 x 36, 22 x 48, 20 x 64, 22 x 64, 20 x 80, 22 x 80 |
| Sidelights   | 8 x 36, 8 x 64, 14 x 64, 8 x 80, 14 x 80                      |
| Doors        | 1.66" to 1.80" thick  |

## TECHNICAL DRAWINGS & SPECIFICATIONS

(Drawings shown with Evolve Frame)

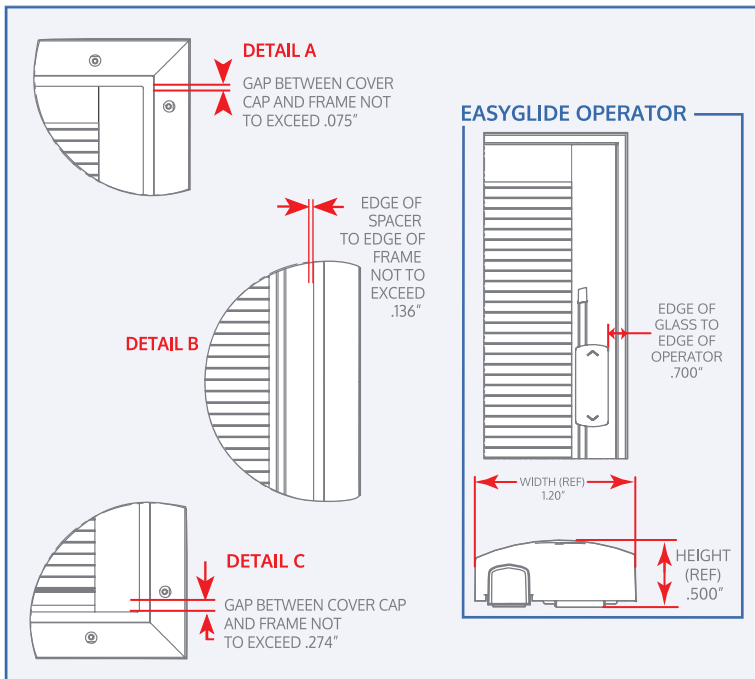
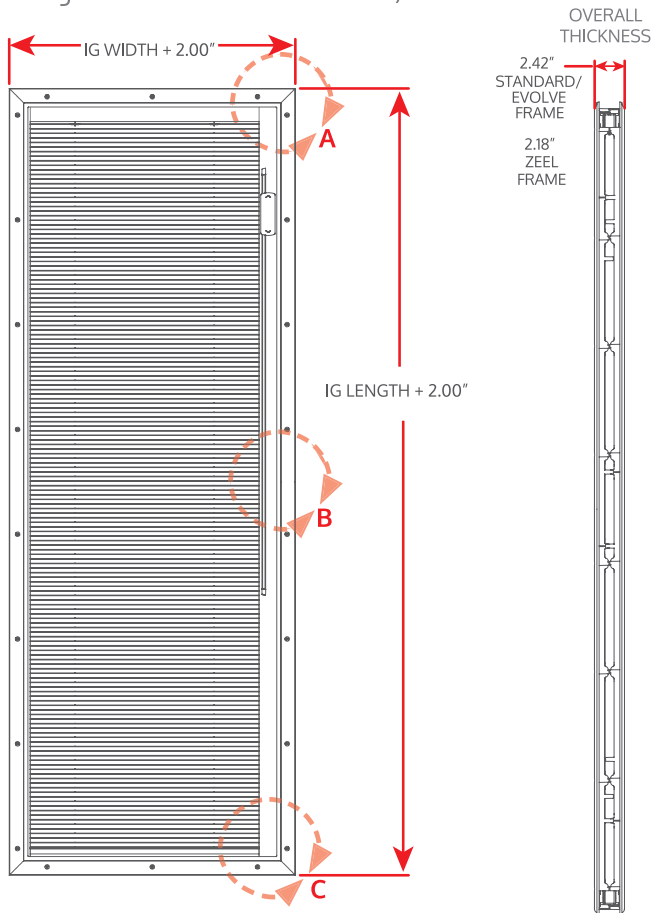

### Operation

|                           |                            |
|---------------------------|----------------------------|
| Blind Function            | Raise, Lower, and Tilt     |
| EasyGlide Single Operator | Single shot                |
| Capillary Tube            | Do not block, crush or cut |
| Operator Hand Position    | Right-hand Only            |

### Code of Compliance

|                 |  |
|-----------------|--|
| IGCC (seal)     | ASTM E2190 seal certification                              |
| ANSI (glass)    | ANSI Z97.1 safety glazing (Applies to tempered glass only) |
| ASTM (glass)    | ASTM C1036-16 flatness & C1048-18 tempered                 |
| ANSI (safety)   | ANSI/WCMA A100.1-14  |
| STC (doorglass) | STC 32   |
| ENERGY STAR®    | Can use in doors to meet ENERGY STAR® criteria             |

### Materials

|                        |   |
|------------------------|---|
| Spacer                 | Intercept®, tin plated steel                      |
| Glass (Clear or Low-E) | 1/8" tempered safety glass                        |
| Single Low-E           | 2nd surface soft coat                             |
| ZEEL Frame             | FiberMate Plus® white                             |
| Standard/Evolve Frame  | FiberPro® oak & HP white                          |
| Blind Slat             | 12.5 mm wide aluminum UV stabilized coating       |
| Sealant                | Dual seal equivalent                              |
| Desiccant              | Desiccant matrix (moisture & chemical management) |
| Decorative Cover Caps  | UV stabilized, heat tolerant polymer              |

### Maintenance

|       |   |
|-------|---|
| Glass | Clean with soap and water or quality window cleaner |
| Frame | Wash with soap and water                            |

### Warranty

|  |
|--|
| 20 year limited blind and glass seal warranty    |
| Limited lifetime FiberPro® and HP frame warranty |