

Series 88

PLYCO

**HEAVY—DUTY
STEEL CLAD
SERVICE DOOR**



Series

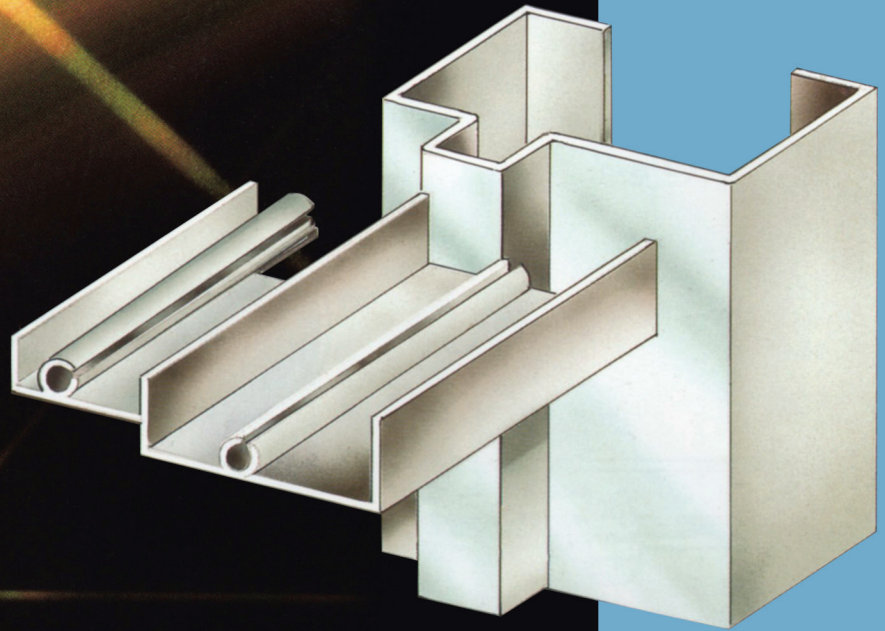

PLYCO

Everlast Quality Door Systems Provide:

- Low Maintenance
- Economy
- Attractive Appearance
- Ease of Installation
- Energy Saving
- Durability

LITE OPTIONS ALL UNITS WHITE OR BRONZE ALUMINUM FRAMES

STANDARD TEMPERED GLASS

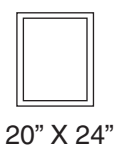

20" X 24"



4" X 48"

WIRE 1/4" WIRE GLASS



16" X 16"

INSULATED 1" THERMO PANE

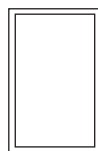

22" X 36"

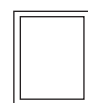

20" X 24"

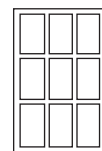

22" X 36"
9 Lite



16" X 16"

DECORATIVE CROSS BUCK EMBOSS - WHITE OR BRONZE

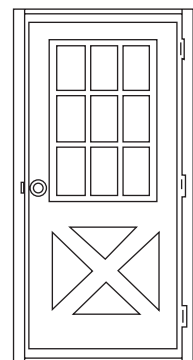

88

INSULATED SERVICE DOORS PRE-HUNG 4-WAY UNIVERSAL SWING

- 3½" Pre-Hung Frame System - 16 Gauge Pre-Painted Steel Verticals
- 4-Way Universal Swing
- White or Bronze Insulated Door Panels - 24 Gauge Baked Enamel Finish
- Individually Cartoned
- 3 Fixed Pinned Hinges
- 6'8" and 7'0" Heights Standard

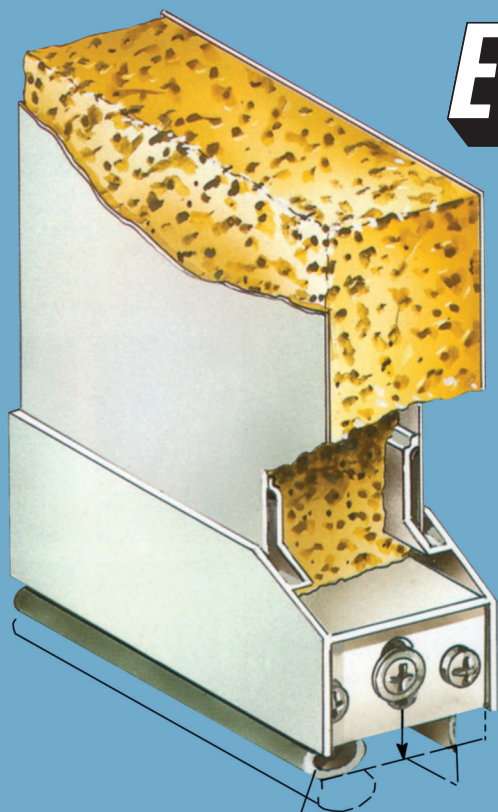

Everlast

Prefinished Insulated Door System

Today's Service Door Answer for Heavy-Duty Construction Applications

Polyurethane Foam Core - poured in place for superior insulating quality - 11.53 R-Factor

Basic unit consists of painted 16 gauge steel framed door with 24 gauge smooth steel panel, 3 fixed pinned hinges applied. Panel drilled to receive standard 2¾" backset w/face plate plunger style lockset. Door is complete with threshold and header. Units are individually cartoned with installation screws included.

- Full Perimeter Adjustable Weatherstripping

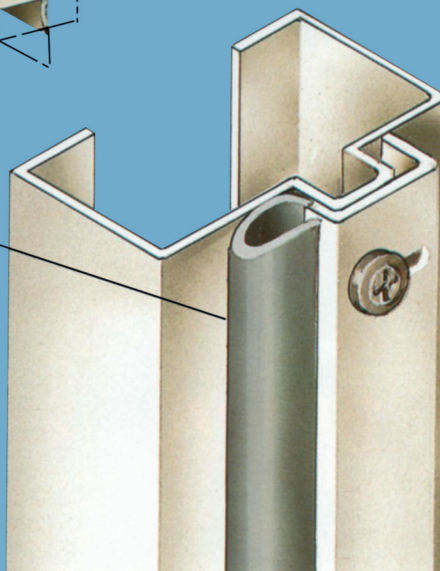

Due to Plyco Corporation's ongoing commitment to product improvement, we reserve the right to change, without notice, product specifications, availability, prices and conditions of sale.

Products are shown with options, please contact your representative.

Series 88 Adapts to All Steel, Masonry, and Wood Applications

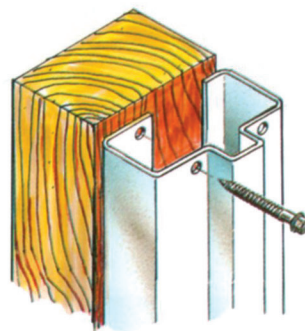
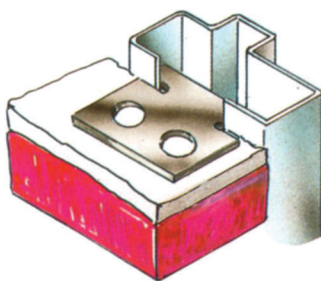
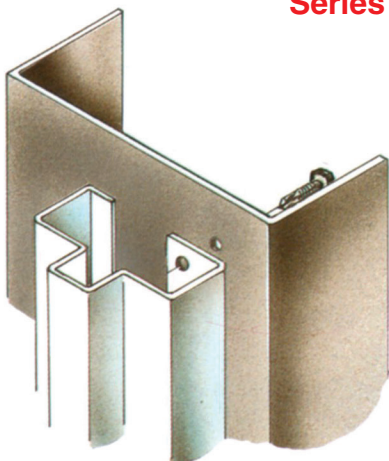

SPECIAL OPTIONS

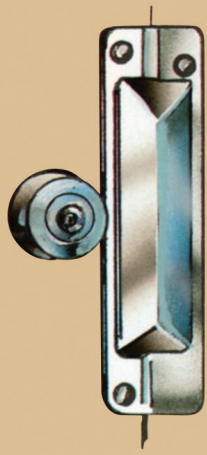

LATCH
GUARD

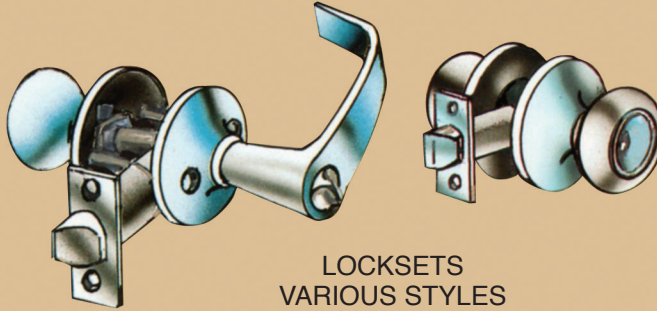

LOCKSETS
VARIOUS STYLES



KICK PLATES

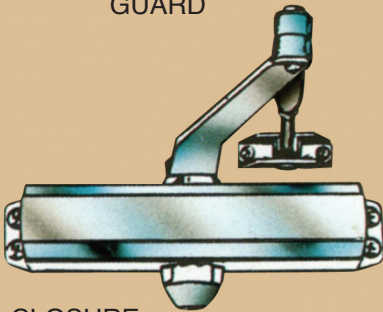

CLOSURE

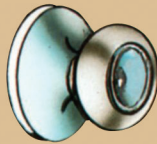

KNOB
LOCK



PUSH/PULL
PLATES

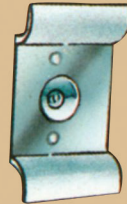

MASONRY
CLIPS

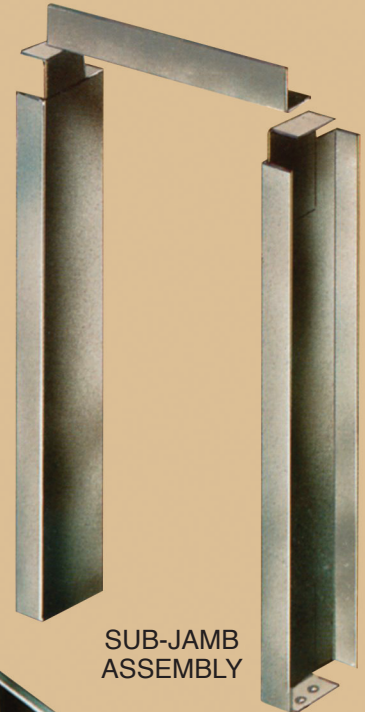

SUB-JAMB
ASSEMBLY

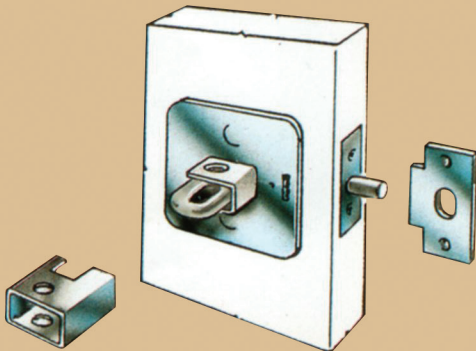

SELF-STORAGE
LOCK

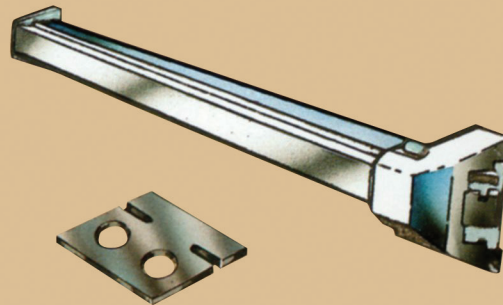

PANIC HARDWARE



MODULAR BLOCK
ALUMINUM HEADER

STANDARD DOOR SIZES



2468



2668



2868

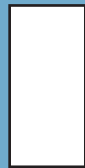

3068



3668



4068



3070



3670



4070

Also Available - Full Line of Double & Special Size Doors

PLYCO
CORPORATION

Elkhart Lake, WI 53020

USA
800-558-5895
Fax 800-257-5926

INTERNATIONAL
920-876-3611
Fax 920-876-3527

DISTRIBUTED BY