



DOOR ACCESSORIES

HARDWARE & BLOCKING

4400 CLOSER CLOSER-HD

- Grade 1 - fits most standard use applications
- Aluminum (689) Finish STD
- Cover included
- Aluminum Alloy body
- Triple valves adjustments
 - Closing Speed
 - Latching Speed
 - Back Check
- Power adjustments (1-6)
- STD parallel arm brackets
- Optional hold open arm
- Same footprint as Yale 50 & Norton 1600 closer
- ADA compliant



8000 CLOSER CLOSER-COM

- Grade 1 HD - for large, heavier or heavy use applications
- Aluminum (689) Finish STD
- Cover included
- HD Cast Iron body
- Triple valves adjustments
 - Closing Speed
 - Latching Speed
 - Back Check
- Power adjustments (1-6)
- STD parallel arm brackets
- Optional hold open arm
- Same footprint as LCN4040 closer
- ADA compliant



HINGES

- 99: 4x4 loose pin zinc
Options: Stainless and fixed pin
- 95: 4x4 fixed pin zinc
Option: Stainless steel
- 92: 4 1/2" x 4 1/2" Stainless steel
Option: Ball bearing
- 20: 4x4 fixed pin Stainless steel.
Option Ball bearing
- 22/23: 4 1/2" x 4 1/2" fixed pin ball bearing stainless steel



ELECTRIC STRIKES

ELECSTRHES9500

- Used when panic device present
- Surface mounted, no frame prep needed
- Any door series with panic



ELECSTRTRI3024

- Used cylindrical locks on any Plyco frame with a "T" strike
- Series 20, 95, 99, etc.



ELECSTRADVES50

- Used cylindrical locks on any Plyco frame with an "ASA" strike
- Series 22/23 and 92



ELECTRONIC KEYPAD LOCKS

Common Features Include

- Grade 1 Commercial
- Touch Screen
- 1,000 User Codes
- Passage Mode
- RFID Keyfob Enabled
- Key Override



Other hinges:

- Spring hinges (option for 4x4 or 4 1/2" x 4 1/2")
- 6" Stainless T hinge (98 series door)

Finishes:

- Stainless Steel - US32D
- Zinc Black - US19
- Zinc - USP ALU



COMMON BLOCKING & BORING

- Deadbolt Door Preps NOT Bored Unless Requested

Exception: SU2 Prep has both holes bored

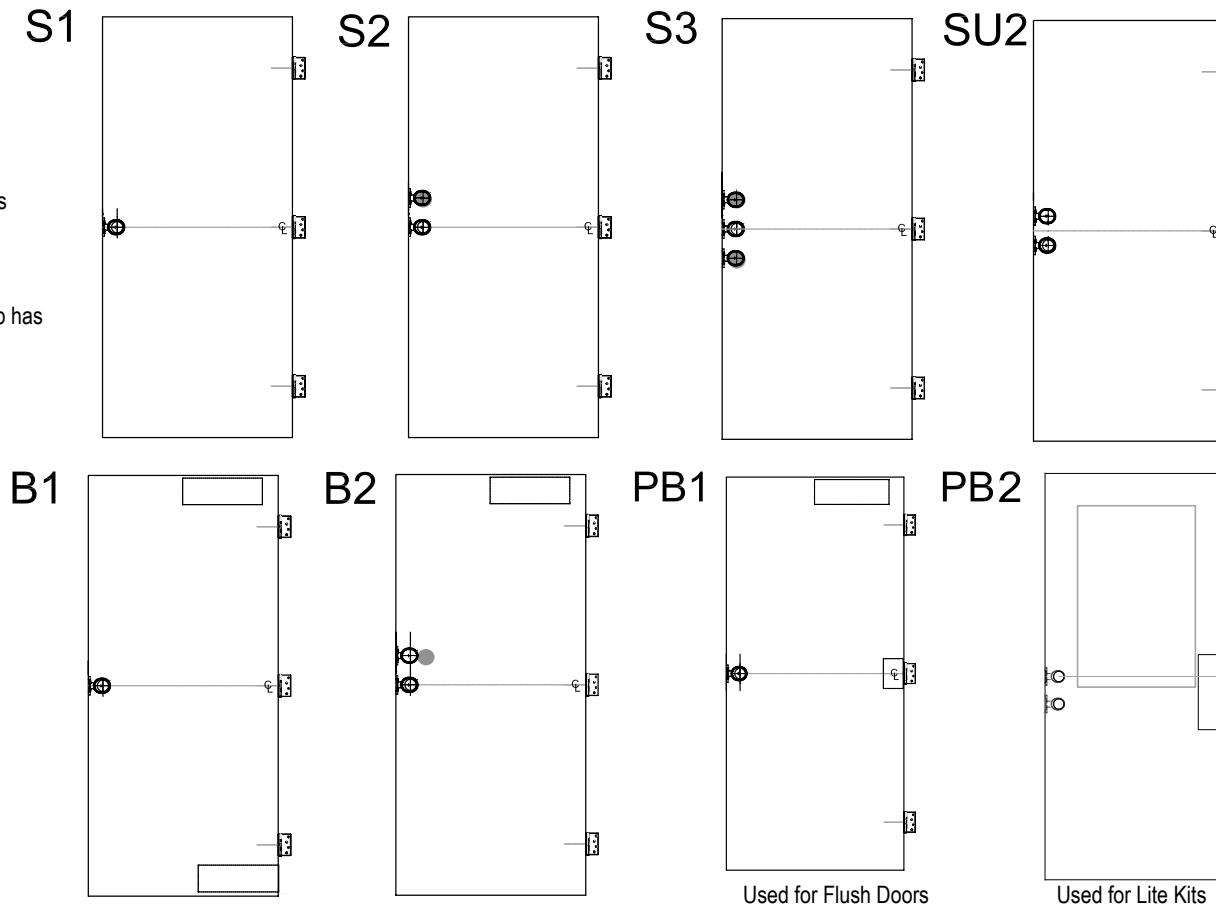

COMPOSITE LOCK REINFORCEMENT



STEEL CLOSER REINFORCEMENT

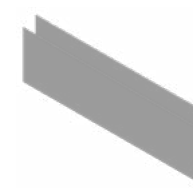

Stock/Standard Finishes

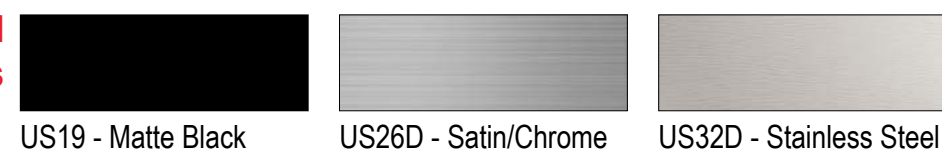

Additional Finish Options

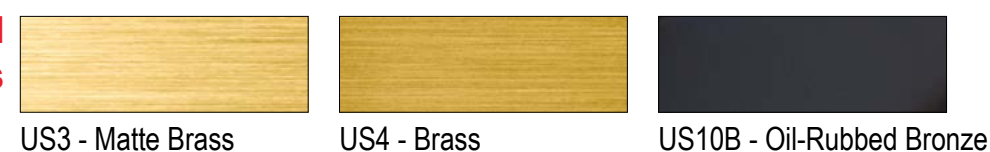

Not all components come in each finish color. Please check for availability. Because of its ongoing commitment to product improvement, Plyco Corporation reserves the right to change, without notice, product specifications, availability, prices and conditions of sale.



Shown: Series 92 - Designer Series

LOCKS • PANICS • CLOSERS
ELECTRIC STRIKES • BLOCKING

FOR ALL APPLICATIONS

CYLINDRICAL LOCKS

KNOBS & LEVERS

MORTISE, INTERCONNECTED, DEADBOLTS, KICKPLATES & LATCHGUARDS

PANICS

MORTISE, INTERCONNECTED & DEADBOLTS

GRADE 3 KNOB (Tubular)

LOCK-EZ-3K/K
US32D - Stainless Steel - Tulip Knob Design

- 2 1/4" x 1" square faceplate / adjustable
2 3/8" - 2 3/4" backset



GRADE 2 KNOB (Cylindrical)

LOCK-EZ-2K/K
US32D - Stainless Steel - Bala Design

- 2 1/4" x 1" square faceplate / fixed
2 3/4" backset



CYLINDER & IC CORES

STANDARD
Schlage C & E Keyway

OPTIONAL IC CORE
Best or Schlage
Compatible



GRADE 3 LEVER (Tubular)

LOCK-EZ-3L/L
US26D - Satin Chrome Finish - Charlotte Design

- 2 1/4" x 1" square faceplate / adjustable
2 3/8" - 2 3/4" backset



GRADE 2 LEVER (Cylindrical)

LOCK-EZ-2L/L
US26D - Satin Chrome Finish - Charlotte Design

- 2 1/4" x 1" square faceplate / fixed
2 3/4" backset



GRADE 1 LEVER W/CLUTCH (Cylindrical)

LOCK-EZ-1L/L-C
US26D - Satin Chrome Finish - Charlotte Design

- 2 1/4" x 1 1/8" square faceplate / fixed
2 3/4" backset



GRADE 2 LEVER W/CLUTCH (Cylindrical)

LOCK-EZ-2L/L-C
US26D - Satin Chrome Finish - Charlotte Design

- 2 1/4" x 1" square faceplate / fixed
2 3/4" backset



Clutch Option - In locked position lever can still be depressed to reduce torque on the lever

GRADE 2 INTERCONNECTED LOCK

LOCK-CR-2L/D-IC
US26D - SATIN CHROME

- High Security
- 5.5" Center of Deadbolt to Center of Lock



MORTISE LOCK

LOCK-MORT-720ME
US26D - SATIN CHROME

- High Security



KICKPLATES, LATCHGUARDS & PUSH/PULLS



DEADBOLTS

GRADE 3 SINGLE CYLINDER
LOCK-EZ-3KLDLK
US32D - STAINLESS STEEL



GRADE 2 SINGLE CYLINDER
LOCK-EZ-2K/LDLK
US32D - STAINLESS STEEL



GRADE 2 DOUBLE CYLINDER
LOCK-EZ-2K/KDLK
US32D - STAINLESS STEEL



INDUSTRIAL - 2500 PANIC - GRADE 1 PANIC-ABAR36/48



Chassis - Steel
Rail - Heavy Gage Steel
Finish - Aluminum
Head Cover/Touch Bar/End Cap
Plates Zinc Alloy



500L TRIM
Satin Chrome - US26D



700TL TRIM
Satin Chrome - US26D

ARCHITECTURAL - 9500 PANIC - GRADE 1 PANIC-AB3695F/AB4895(F)



Finish - Stainless Steel US32D
Chassis - Stainless Steel
Rail - Extruded Aluminum
Head Cover/Touch Bar/End Cap
Stainless Steel



500L TRIM
Satin Chrome - US26D



900ETM TRIM
Satin Chrome - US32D

INDUSTRIAL 2700 VERTICAL PANIC - GRADE 1 PANIC-ABAR36VER



Chassis - Steel
Rail - Heavy Gage Steel
Finish - Aluminum
Head Cover/Touch Bar/End Cap
Plates Zinc Alloy



500L TRIM
Satin Chrome - US26D



700TL TRIM
Satin Chrome - US26D

ALL LOCKS: Fire Rated
UL Listed

LOCK PERFORMANCE:

Grade 1 - Heavy Duty - 800,000 cycles
Grade 2 - Standard - 400,000 cycles
Grade 3 - Light Duty - 200,000 cycles

ENTRY FUNCTION: Inside Push Turn Button - Outside Key
Exterior Lever - Rigid when locked

LOCK FUNCTIONS: Entry • Storeroom
Privacy • Passage

PANIC PERFORMANCE:

Grade 1 - 500,000 cycles
Grade 2 - 250,000 cycles