

Installation Instructions for:

**Project Type -**

New Construction

Coastal Installation -

No

Product Series -

100 Series

Product Type -

Gliding Window

Shape -

Rectangle

Wall Type -

Wood or Steel Stud

Weather Resistant Barrier (House Wrap) -

Applied Before Window/Door Installation

Water Management Method -

Barrier Method

Sill Flashing Method -

Single Piece (Continuous Pan or Continuous Formable Flashing)

Anchoring Method -

Vinyl Installation Flange (only)

Drip Cap Pre-applied -

No



Read these instructions and the product safety information before starting procedure.

Parts Included:

- Window
- Important Product and Safety Information
- Resource Directory
- Warranty

Typical Tools Needed



General Supplies Needed

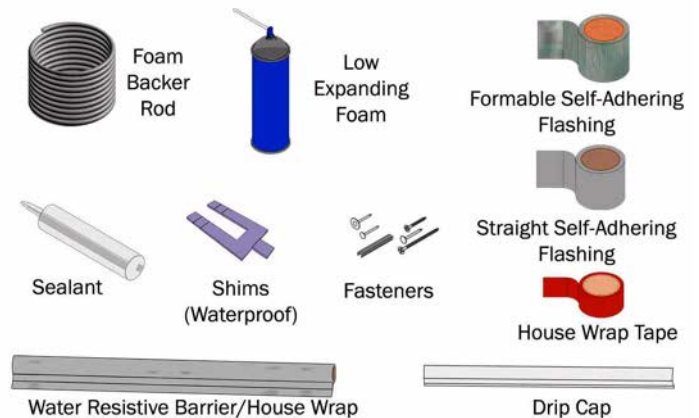

FASTENER CHART

INSTALLATION FLANGE ANCHORING REQUIREMENTS (select one)

Fastener	Substrate	Minimum Head	Minimum Shank	Minimum Embedment to Structural Framing	Steel Type/Coating	Spacing
Roofing Nail	Wood	5/16"	11 ga	1-1/2"	Galvanized, Zinc Chromate, *Stainless Steel, *Ceramic Coated	Every Hole
Wood Screw	Wood	5/16"	#6			
Self-Tapping Metal Screw	Metal	5/16"	#8	3 Full Threads		

INSTALLATION GUSSET PLATE ANCHORING REQUIREMENTS (select one)

Fastener	Substrate	Minimum Head	Minimum Shank	Minimum Embedment to Structural Framing	Steel Type/Coating	Spacing
Wood Screw	Wood	5/16"	#10	1-1/2"	Galvanized, Zinc Chromate, *Stainless Steel, *Ceramic Coated	Every Hole
Self-Tapping Metal Screw	Metal	5/16"	#10	3 Full Threads		
**Concrete Screw	Masonry	5/16"	3/16"	1-1/4"	n/a	**Every Hole (except where minimum spacing cannot be met)

Use the correct fastener driver based on the selected fastener's head type.

Size pilot and clearance holes based on the selected fastener's shank diameter as needed.

*Use 300 series stainless steel or ceramic coated fasteners when fastening to treated lumber.

**Follow fastener manufacturer's anchoring recommendations (i.e. spacing, edge distance, hole depth, etc.)

Important Safety and Product Information

for Andersen® Windows and Doors



This is the Safety Alert Symbol used to alert you to potential injury hazards. Obey all safety messages that follow this symbol to avoid possible injury or death.

Signal Word and Consequence

COULD

Result in:



COULD

Result in:



COULD

Result in:



Read this Important Safety and Product Information completely before starting.

Safety and Product Information Index

- | | |
|----------------|-----------------------|
| ■ Tools | ■ Glass |
| ■ Handling | ■ Protective Film |
| ■ Installation | ■ Cleaning |
| ■ Sealing | ■ Use/Operation |
| ■ Fastening | ■ Joining |
| ■ Finishing | ■ Product Information |

- Leave this installation instruction with the home/building owner.
- For additional support or help please go to: andersenwindows.com and visit our Help Center.
- To configure installation instructions go to: andersenwindows.com/installation

Tools

WARNING

- Follow manufacturers' instructions for hand and power tools. Always wear safety glasses. Failure to do so could result in injury, product or property damage.

Handling

WARNING

- Windows and doors can be heavy. Use safe lifting techniques and a reasonable number of people with enough strength to lift, carry, and install window and door products. Heavier windows and doors will require mechanical assistance. Failure to do so could result in injury, product or property damage.
- **DO NOT** lift or carry window or door by the exterior trim or extension jambs. Doing so could result in injury, product or property damage.
- Windows, doors, and installation components can have sharp edges. Wear protective equipment when handling. Failure to do so could result in injury.
- **DO NOT** drag, rock, cartwheel, or walk windows, doors, sash, or panels across the floor. Doing so could result in product or property damage.

Installation

WARNING

- Use caution when working at elevated heights and around window and door openings. Follow the manufacturers' instructions for ladders and scaffolding. Failure to do so could result in injury or death.
- Support window or door in opening at all times until fully fastened. Failure to do so could result in window or door falling out causing injury, property or product damage.
- Windows and doors have small parts (e.g. hole plugs, operator spline caps, fasteners, etc.). Small parts if swallowed could pose a choking hazard to young children. Dispose of unused, loose, or easily removed small parts. Failure to do so could result in injury.

Installation (Continued)

NOTICE

- Andersen head flashing and installation flanges **DO NOT** take the place of window and door flashing tape or liquid flashing. Window or door must be properly flashed and sealed with a material compatible sealant for protection against water and air infiltration. Failure to do so could result in product or property damage.
- **DO NOT** set window or door directly on installation flange. Doing so could affect product performance, and could result in product or property damage.
- **DO NOT** set window directly on sill plate. Elevate window with shims under the side jambs. Failure to do so could affect operation and product performance, and could result in product damage.
- Window or door must be properly shimmed. Failure to do so could affect operation and product performance, and could result in product damage.
- A continuous full perimeter interior seal between window or door frame and opening is required. Failure to do so will affect product performance, and could result in product or property damage.
- Protect window and door sills during installation and throughout construction. Failure to do so could result in product damage.
- **DO NOT** remove window or door packaging material until instructed to do so. Doing so could result in product damage.

Sealing

CAUTION

- Follow instructions of foam, sealant, and flashing manufacturers regarding safety, material application, compatibility, and periodic maintenance for continued weather resistance of their products. Failure to do so could result in injury, product or property damage.

NOTICE

- Clean and prepare surfaces receiving sealant following sealant manufacturer's instructions. Failure to do so could result in water infiltration causing product or property damage.
- **DO NOT** use abrasive cleaners or solvents when cleaning Fibrex® material. Doing so could result in product damage. Go to andersenwindows.com for a list of recommended cleaners.

Fastening

WARNING

- Metal fasteners and components could corrode when exposed to preservative-treated or fire-retardant treated lumber. Use approved fasteners and components to fasten window or door. Failure to do so could cause a failure resulting in injury, product or property damage.
- Fastener must attach to a structural framing member with a 1-1/2" minimum fastener embedment. Failure to do so could result in injury, product or property damage.
- **DO NOT** remove screws that attach installation clips or gusset plates to window or door frames. Doing so could result in injury, product or property damage.

NOTICE

- Use masonry screws when fastening directly into masonry or through a buck into masonry. Failure to do so could affect product performance, and could result in product or property damage.
- **DO NOT** over drive screws or nails. Doing so could result in product damage.
- Fasteners must be attached to a structural framing member. Failure to do so will reduce the structural performance to less than published values and could affect product performance, and could result in product or property damage.

Finishing

NOTICE

- **DO NOT** stain or paint weatherstrip, vinyl, glass, or hardware. Doing so could result in product damage.
- Read and follow finish manufacturer's instructions and safety information. Failure to do so could result in product damage.
- **DO NOT** over load brush with stain or paint when finishing. Doing so could allow finish to wick between glass stop or grille, and glass.

Finishing (Continued)

NOTICE

- Finish all wood surfaces immediately after installation. Unfinished wood will deteriorate, discolor, and could bow or split. Some surfaces are hidden from view.

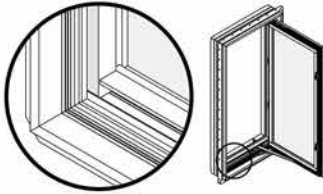

- Some products are shipped unassembled, and it may be more convenient to finish wood surfaces for these products prior to assembly and installation.

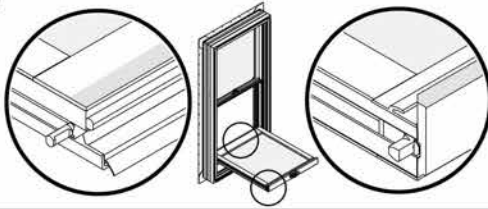

Glass

WARNING

- Unless specifically ordered, Andersen windows are not equipped with safety glass, and if broken, could fragment causing injury. Many laws and building codes require safety glass in locations adjacent to or near doors. Andersen windows are available with safety glass that could reduce the likelihood of injury when broken. Information on safety glass is available from your local Andersen dealer.
- Tempered or laminated safety glass is not standard for windows and must be special ordered. Check local building codes for required locations. Failure to do so could result in injury, product or property damage.

NOTICE

- **DO NOT** apply any type of film to insulating glass. Doing so could cause thermal stress conditions and result in glass damage. Shading devices (e.g. insulated coverings, shutters, etc.) could also cause thermal stress and condensation causing deterioration of windows or doors.

- **DO NOT** use sealants on exterior or interior glass surface.



Protective Film

WARNING

- **DO NOT** place suction grips over film seams on glass. Suction grips will not hold if placed over film seam to lift or move window or door. Window or door will fall and could result in injury, product or property damage.



- **DO NOT** remove any protective film near flammable materials. Static charge created when removing film can ignite flammable materials or cause a shock. Doing so could result in injury, product or property damage. **See warning label on glass.**

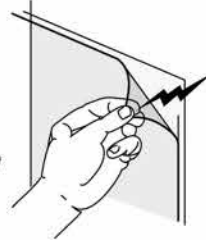

- Dispose of protective film immediately after removing. Failure to do so could pose a suffocation hazard to children.

NOTICE

- **DO NOT** remove protective film from glass until after construction is completed. Doing so could allow glass to be damaged.
- Remove protective film from non-glass components immediately after installation. Failure to do so could result in product damage.

Cleaning

NOTICE

- Acid solutions used for cleaning masonry or concrete will damage all components of window or doors. Protect window or door and follow cleaning product manufacturer's instructions. If acid contacts window or door, wash all surfaces immediately with clean water.
- **DO NOT** use or apply solvents, abrasives, harsh chemicals or cleaners to window or door components. Doing so will result in product damage. For a list of recommended cleaners go to: andersenwindows.com

- **DO NOT** use metal razor blades to clean glass surface. Glass damage could result.

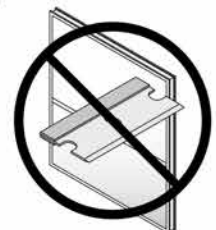

Use/Operation

WARNING

- **DO NOT** stand in front of or near windows or doors during a storm. Doing so could result in injury. Accessories such as grilles, art glass, and insect screens could dislodge and become airborne if window or door is impacted by wind-borne debris from severe storms or hurricane strength winds. In the event of a storm, remove all accessories from windows or doors and move to a safe location.

- **DO NOT** install air conditioner in window. Doing so could result in injury, product or property damage.



- Wind load brackets must be flipped out when not tilting or cleaning. If wind load brackets are not flipped out, window could blow in resulting in potential injury and/or product damage.

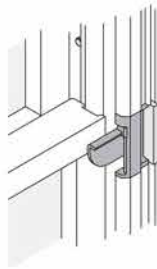

Flipped Out

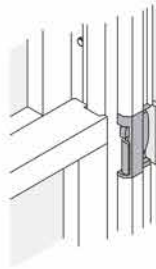

Flipped In

CAUTION

- **DO NOT** attach objects or accessories to window or door except Andersen® products specifically designed for the window or door. Doing so could result in injury, product or property damage.

Joining

WARNING

- **DO NOT** join any window or door, horizontally or vertically, to any window or door not designed for joining. Doing so could result in injury, product or property damage.

- Joined windows or doors must be individually supported in the opening. Failure to do so could affect operation and product performance, and could result in product or property damage.

Product and General Information

IMPORTANT

- Buildings constructed prior to 1978 could contain lead paint which could be disturbed during window or door replacement. For more information on proper management of lead paint, go to: www.epa.gov/lead

- Instructions may not be right for all installations due to building design, construction materials, or methods used and/or building or site conditions. Consult a contractor or architect for recommendations.

- Installation flanges may need to be removed for some installations. (e.g. masonry, replacement), or where exterior finish is already applied (e.g. siding, brick veneer, stucco).

- Installation flange on the window or door alone will not properly flash and seal the window or door.

- **DO NOT** remove band, plastic ties, or packing clips from window or door until instructed.

- **DO NOT** remove performance (NFRC) label until after final inspection. Doing so could delay final inspection and sign-off by the code official.

- Check with your local building code official to identify and confirm compliance with local building code requirements.

- Contact local authorities or waste management company for proper recycling and disposal instructions for removed window or door.

- For cleaning instructions for window and door components go to: andersenwindows.com.

- During construction protect products from construction debris, harsh chemical such as brick wash, roof runoff, and cement/masonry which can cause damage to window and door products.

- Protective film is not present on all windows or doors. Protective film is not a substitute for masking.

- Remove protective film from glass within six (6) months of installation and when temperature is above 32° F.

- Remove protective film by peeling from seam or corner. Use a plastic scraper to start if needed.

- Extension jambs can be factory applied on some windows or field applied prior to installation. **DO NOT** apply extension jambs prior to window or door installation that will be fastened with installation clips. Doing so could prevent access to installation clips for fastening.

- For extension jamb application refer to instructions included with part(s) or go to: andersenwindows.com

- Use painters masking tape for protecting products during construction. Avoid using duct or packaging tapes.

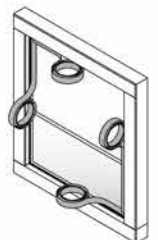

1

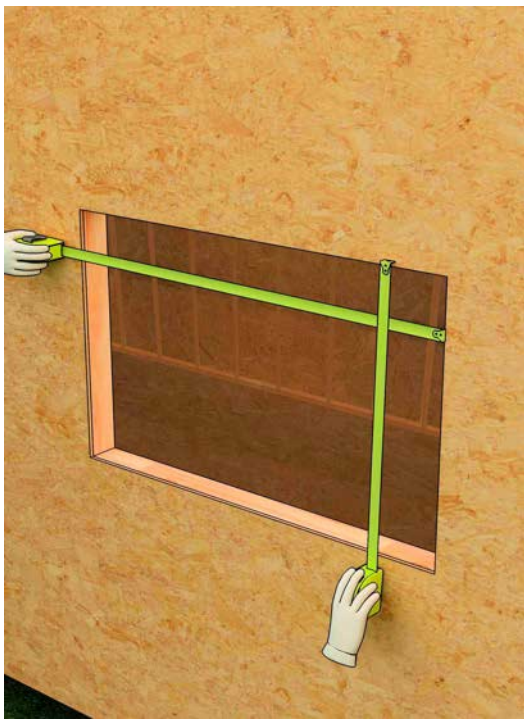

Check that the opening is sized correctly. Allow additional space for flashing thickness, installation clips, joining components, and their fasteners.

2

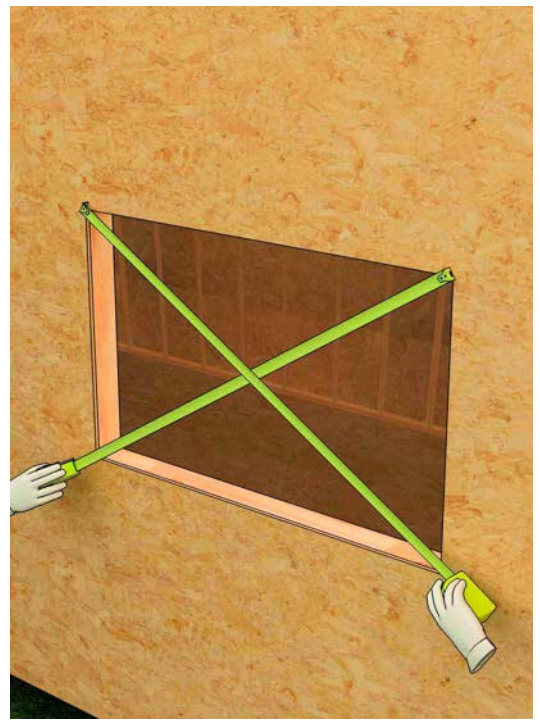

Check that the opening is square. The diagonal measurements should be within 1/8".

3

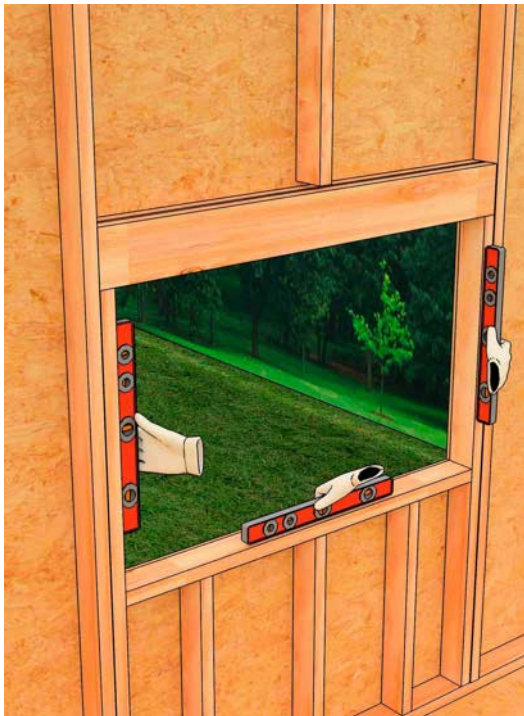

Check that the opening is plumb and level.

4

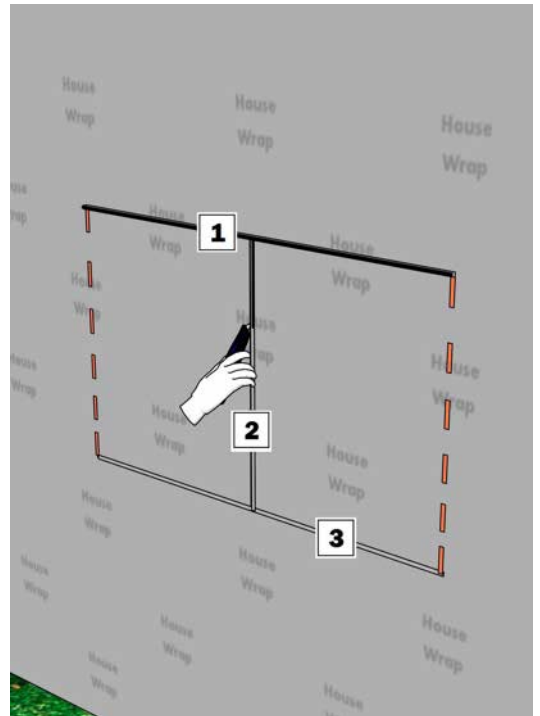

Apply the house wrap according to the manufacturer's instructions and cut opening as shown.

5

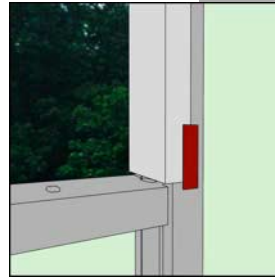
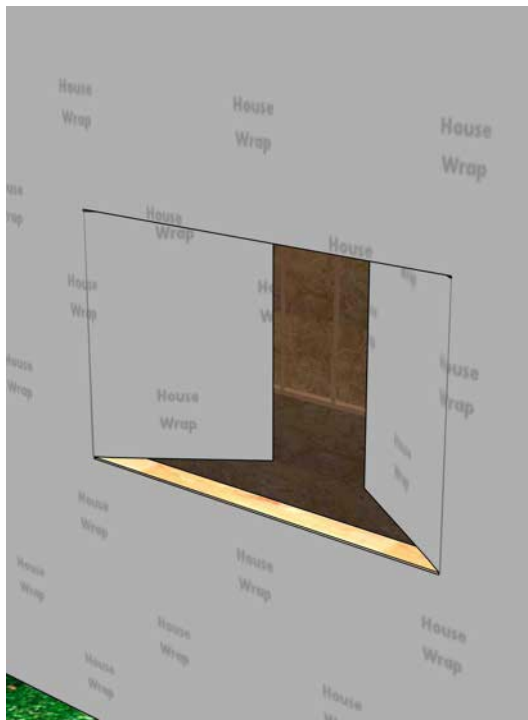

Fold in the house wrap and staple it to the interior of the opening. For steel stud walls, tape house wrap as shown.

6



Cut off the excess house wrap.

7

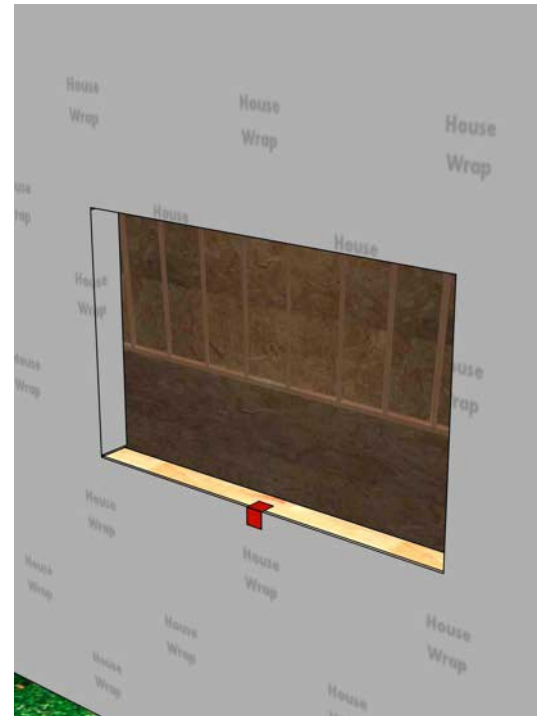

Tape the house wrap at the bottom of the opening as shown.

8

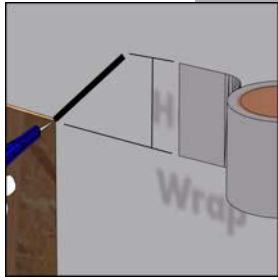

Cut the house wrap to create a top flap as shown.

9

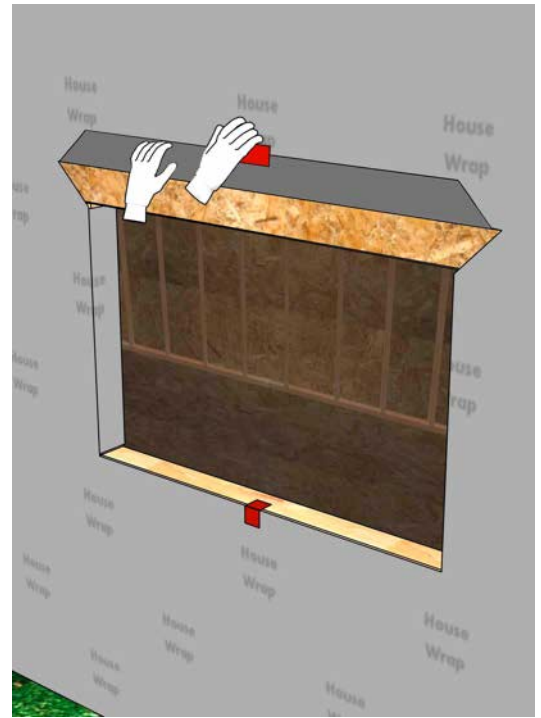

Fold the house wrap flap up and temporarily tape it in place.

10

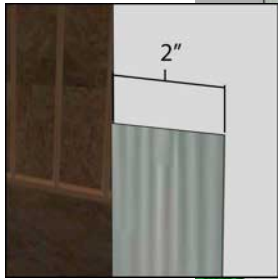

NOTICE

Make sure there are no wrinkles or voids in flashing during application and overlapping. Failure to do so could result in product or property damage.

Apply flashing at the bottom of the opening as shown. Smooth using a J-roller.

11

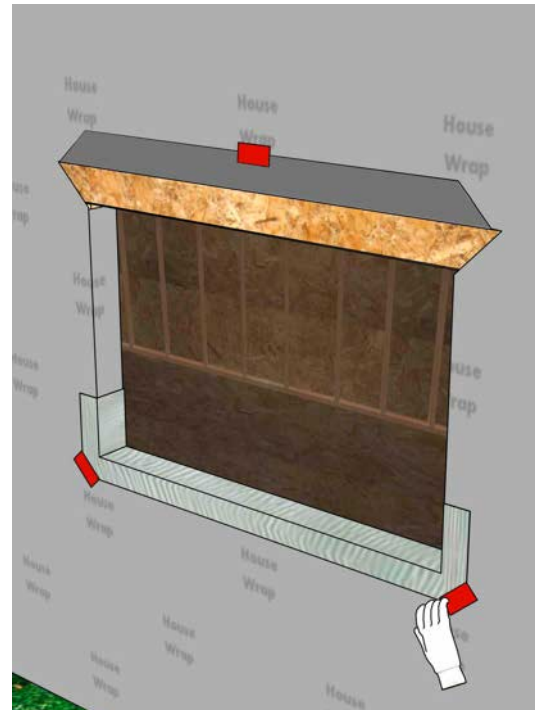

IMPORTANT

Single piece flashing is shown from this point forward, this does not affect the installation process.

Tape the flashing corners as shown.

12



Remove all shipping materials and packaging from window. Verify that sash is closed and locked.

13

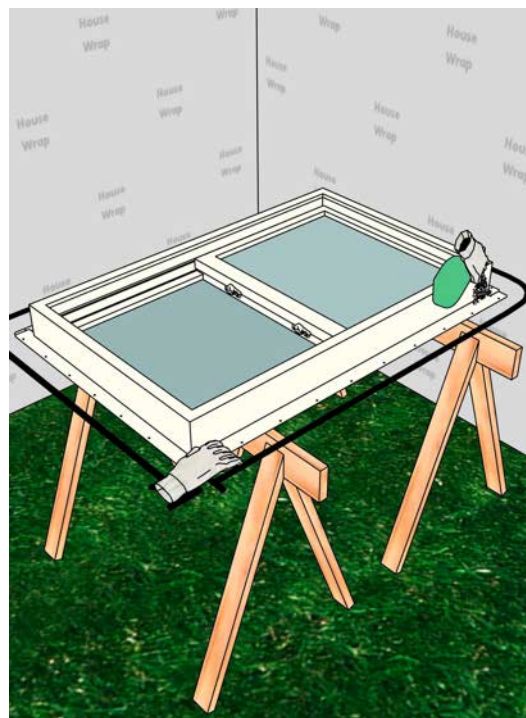

Verify that the installation flanges are clean, dry, and free of debris. If they are not, clean the installation flanges on both sides using soap and water, or a non-abrasive solvent free cleaner. Rinse and dry flanges thoroughly after cleaning.

14

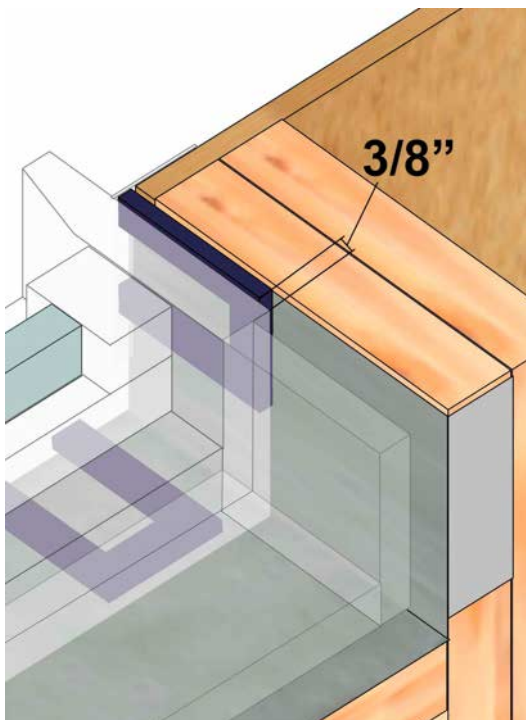
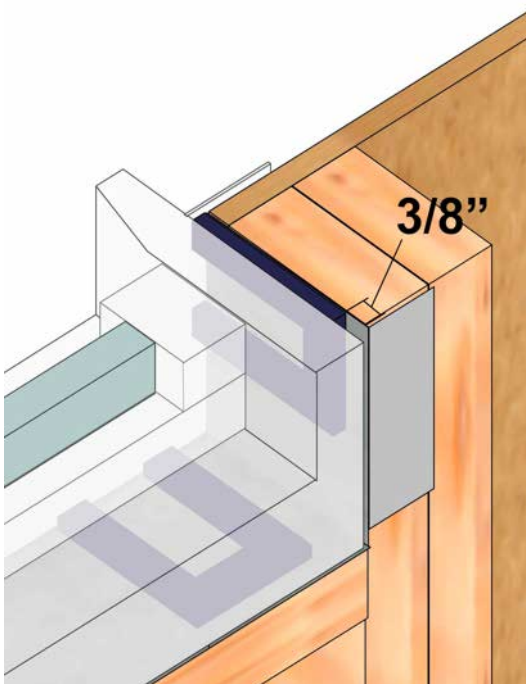

Prepare shims to allow for a 3/8" space for interior sealing as shown.

15

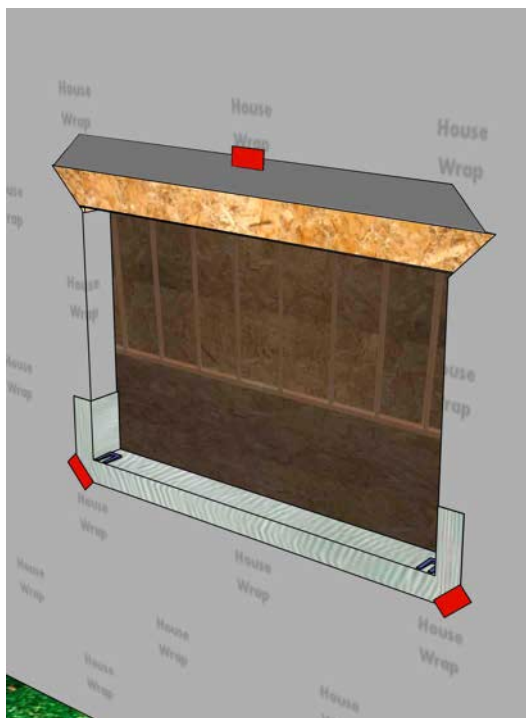

Place shims on the bottom of the opening under the side jamb locations inset 1/4" from each side.

16

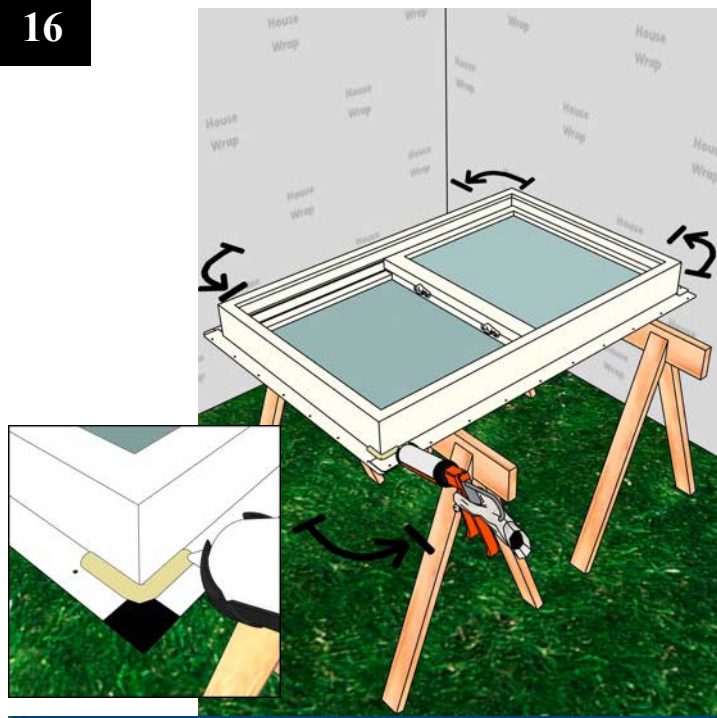

NOTICE

Apply sealant behind installation flange at all corners and seams on interior side. Failure to do so could result in product or property damage.

Apply sealant at all corners and seams as shown.

17

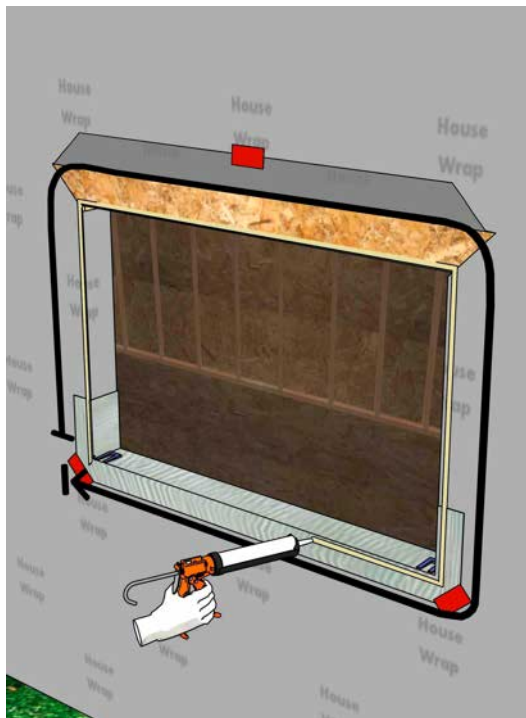

Apply a 1/4" sealant bead to the full perimeter of the opening, no more than 1/2" from the edge as shown.

This area intentionally left blank. Continue to next page.

18

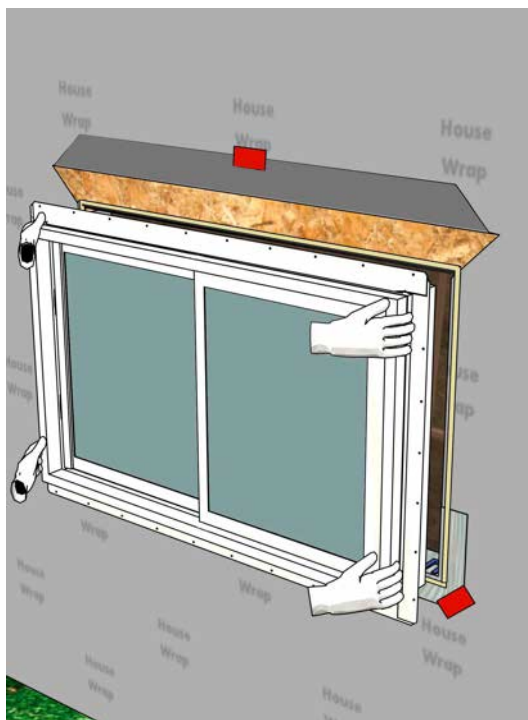

Center the window in the opening, setting the window on the shims. Make sure shims are positioned under the side jambs, meeting stiles, and integral or joined combination locations as shown.

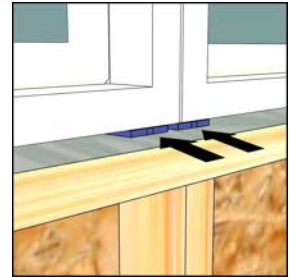
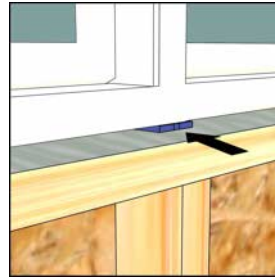

NOTICE

Place shims directly under side jambs, intermediate jambs, and meeting stiles. At gusset plate locations, place shims as close to jambs as possible without interfering with gusset plate screws. Failure to do so could result in product damage and could affect operation.

19



Temporarily fasten with a single fastener at top as shown.

20



Shim at the sides of the window using precut shims.

21

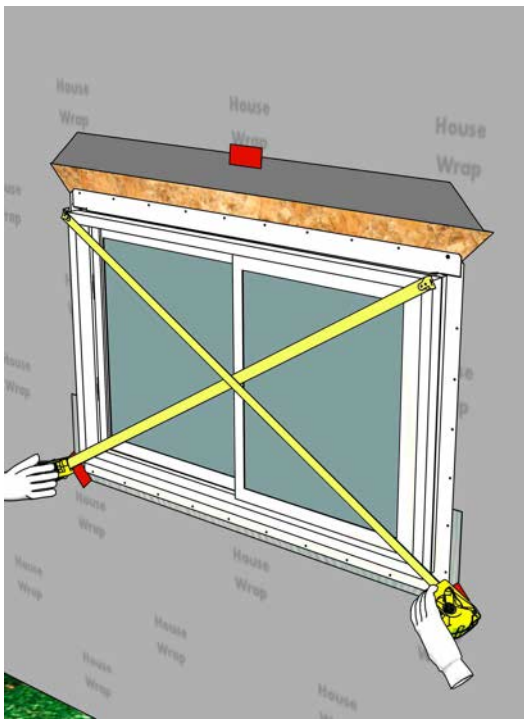

Check that the frame is square. Adjust shims as needed until diagonal measurements are within 1/8".

22

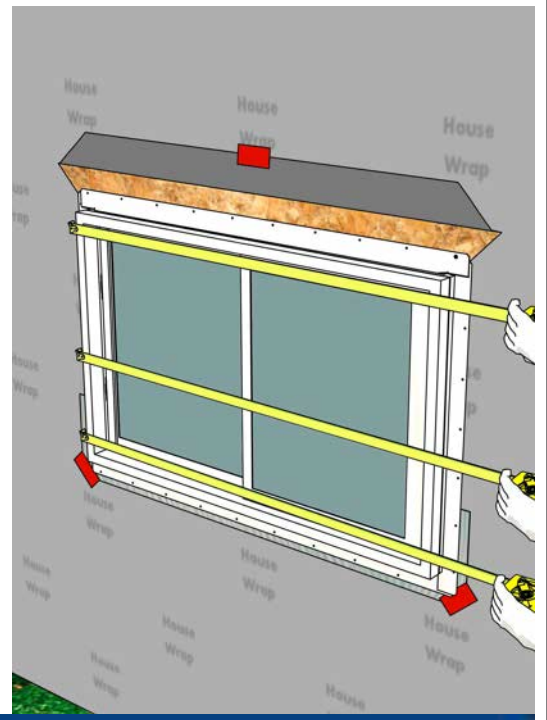

NOTICE

Correct any frame bow during installation. Failure to do so could result in product or property damage and could result in poor operation and product performance.

Check that the frame is not bowed. Adjust shims as needed until measurements are within 1/8".

23

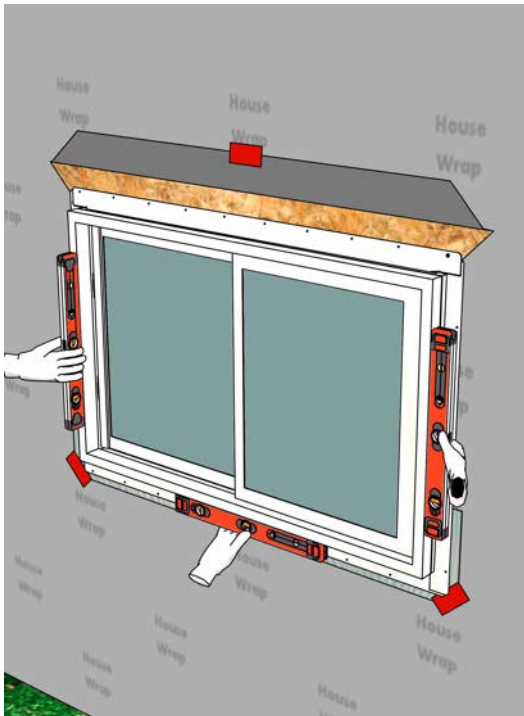

Check that the frame is plumb and level. Adjust shims as needed.

24



Fasten through the installation flanges. See fastener chart for spacing and approved fasteners.

25



For joined units only, apply a 1/4" bead of sealant to the flange gasket and end cap joint as shown.

26

Non-Reinforced Joining

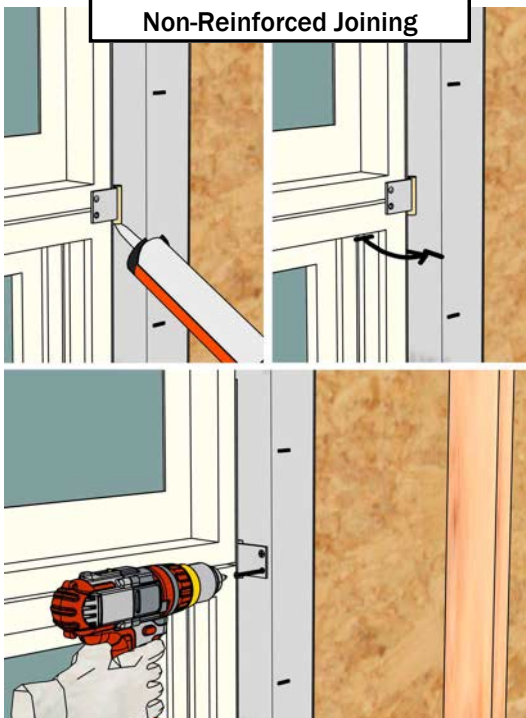

If non-reinforced gusset plates are present, apply sealant between tabs and the opening, bend tabs into position, and fasten tabs as shown. See fastener chart for approved fasteners.

Reinforced Joining



OR

If reinforced gusset plates are present, fasten tabs as shown. See fastener chart for approved fasteners.

27

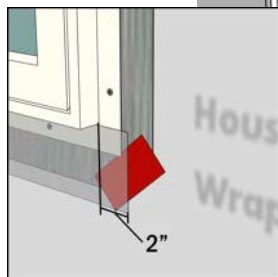

NOTICE

Make sure there are no wrinkles or voids in flashing during application and overlapping. Failure to do so could result in product or property damage.

Apply flashing at the bottom edge, overlapping the installation flange as shown. Smooth using a J-roller.

28

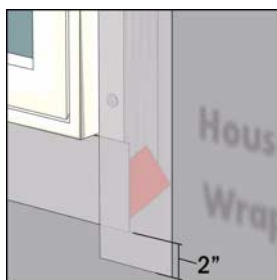
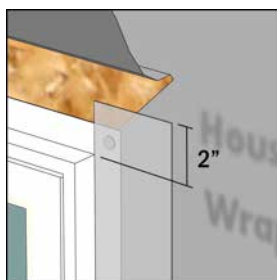
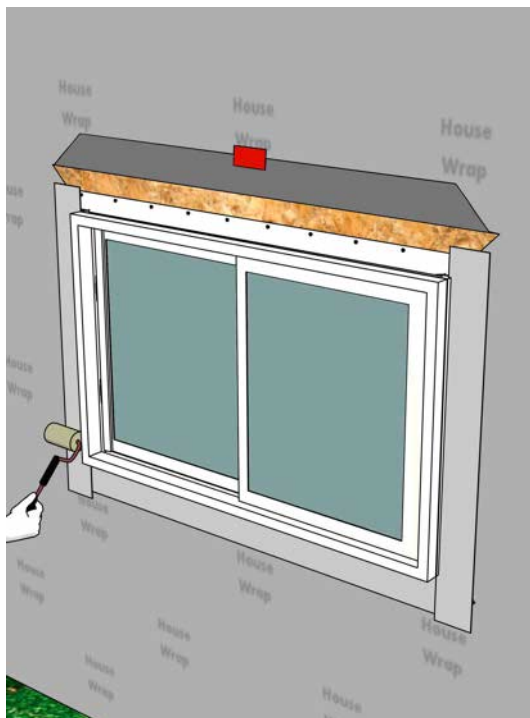

Apply flashing at the sides of the window, overlapping sill flashing as shown. Smooth using a J-roller.

NOTICE

Make sure there are no wrinkles or voids in flashing during application and overlapping. Failure to do so could result in product or property damage.

29

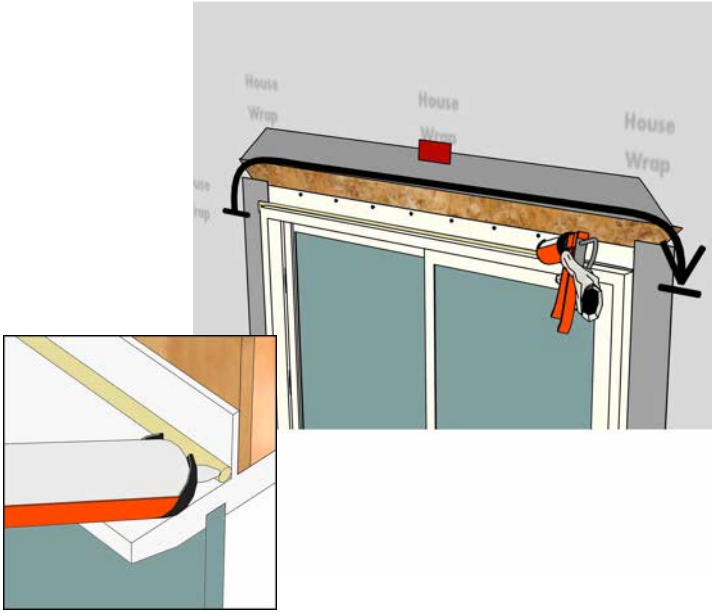

Apply a 1/4" sealant bead to the top and down 1" on both sides where installation flange meets frame. Quickly go to next step.

30

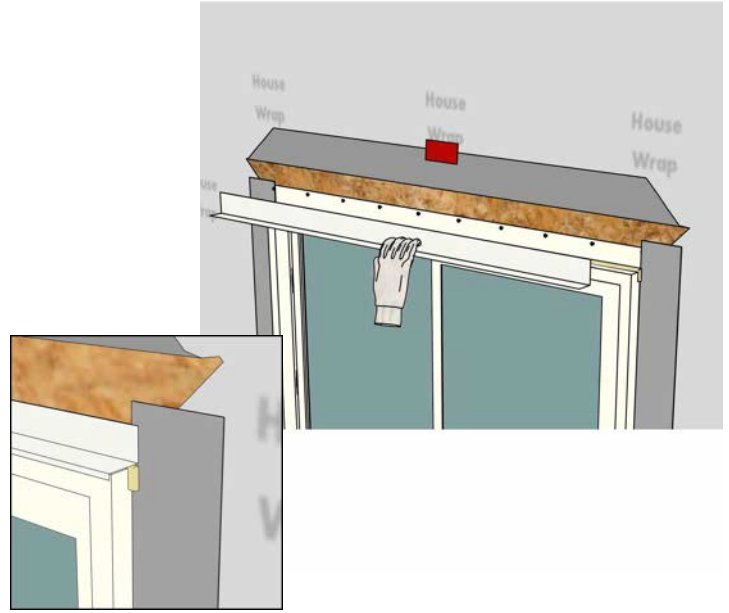

Place the drip cap (full width) in sealant as shown.

31

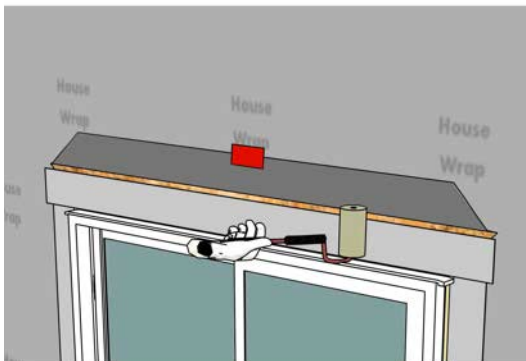

Apply flashing over the drip cap leg, overlapping the side flashing as shown. Smooth using a J-roller.

NOTICE

Make sure there are no wrinkles or voids in flashing during application and overlapping. Failure to do so could result in product or property damage.

Side flashing cannot extend above top flashing. Doing so could result in product or property damage.

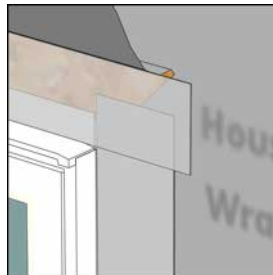

32

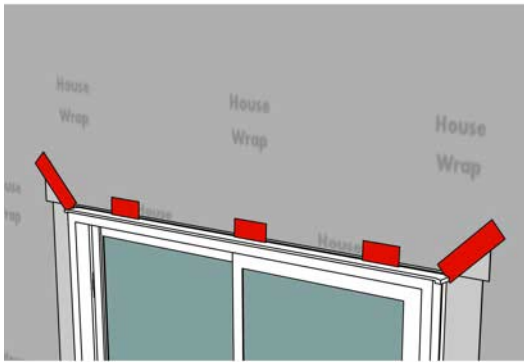

Unfold the house wrap top flap and tape the seams using house wrap tape as shown.

33

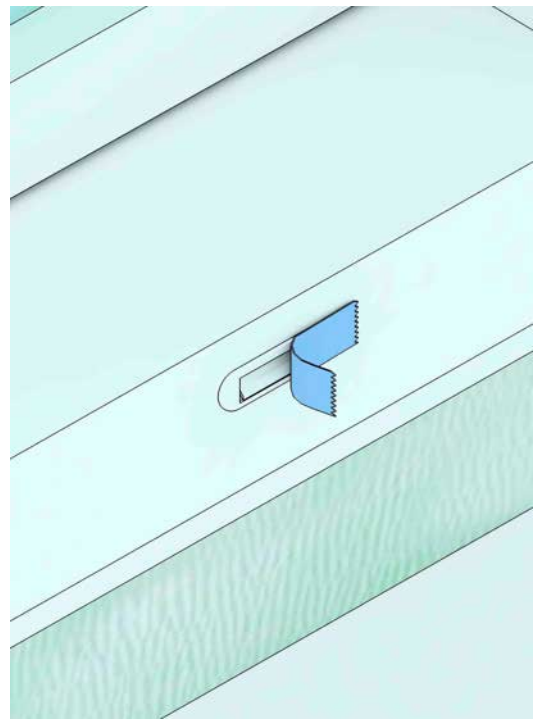

Remove tape covering weep holes.

This area intentionally left blank. Continue to next page.

Low Expanding
Foam Option

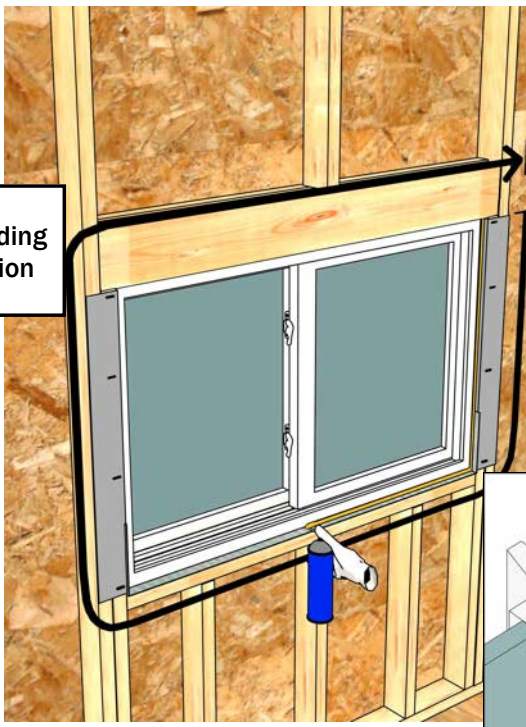

NOTICE

DO NOT overfill with low expanding foam or overpack with backer rod between the frame and opening or between joined windows or doors. Doing so will bow window or door jambs and could result in poor operation and product performance.

OR

Backer Rod and
Sealant Option

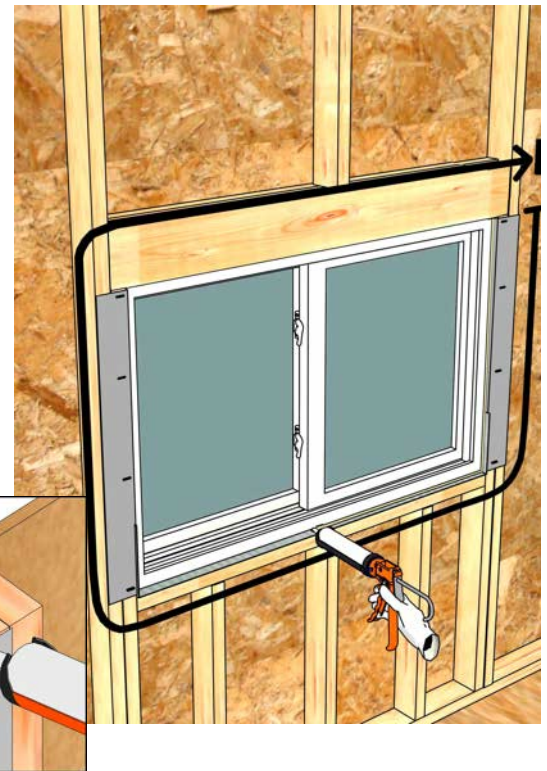
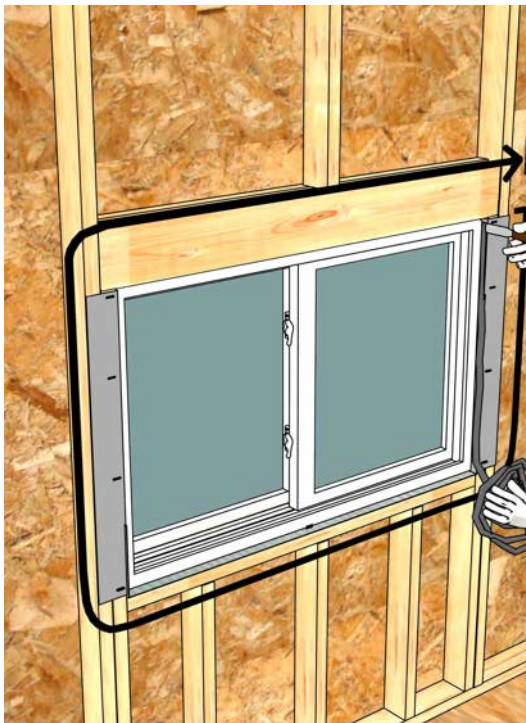

Apply sealant continuously to full perimeter of opening, filling interior 1/3 of cavity as shown using low expanding foam or backer rod and sealant.

Exterior Finishing Instructions for All Windows and Doors



Read these instructions before starting procedure. For additional information visit www.andersenwindows.com. For questions call 1-888-888-7020.

Tools and Supplies Needed



Safety Glasses



Foam Backer Rod



Putty Knife



Caulking Gun



Sealant

WARNING

- Follow manufacturers' instructions for hand and power tools. Always wear safety glasses. Failure to do so could result in injury, product or property damage.
- Use caution when working at elevated heights and around window and door openings. Follow the manufacturers' instructions for ladders and scaffolding. Failure to do so could result in injury or death.

CAUTION

Follow instructions of foam, sealant, and flashing manufacturers regarding safety, material application, compatibility, and periodic maintenance for continued weather resistance of their products. Failure to do so could result in injury, product or property damage.

NOTICE

Clean and prepare surfaces receiving sealant following sealant manufacturer's instructions. Failure to do so could result in water infiltration causing product or property damage.

1

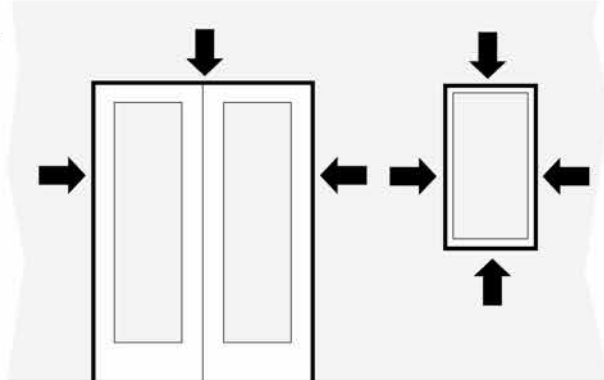

IMPORTANT

Leave 1/4" gap between exterior wall cladding /siding and window or door frame, as shown. For brick, leave 1/2" gap at sill.

NOTICE

Make sure to maintain the proper perimeter spacing around the full unit in order to provide adequate spacing for expansion and contraction of the unit.

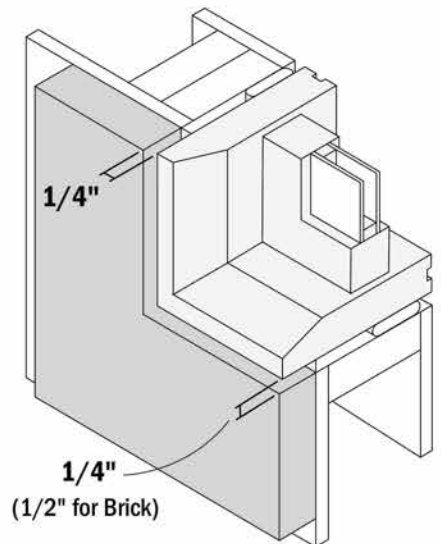

2

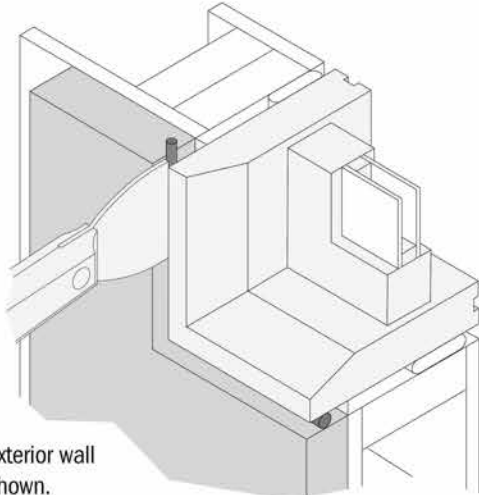

Insert backer rod between frame and exterior wall cladding /siding as shown.

3

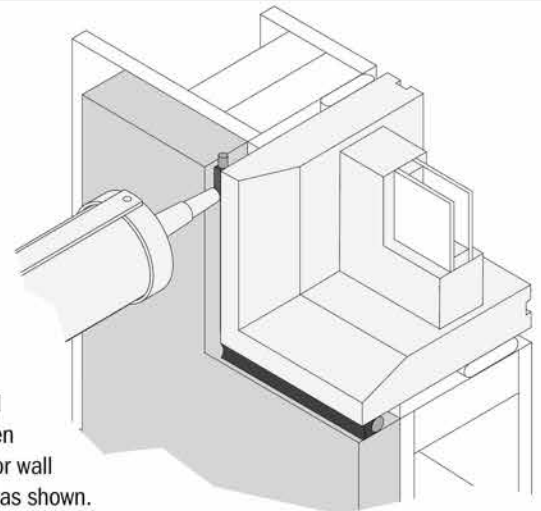

Apply sealant full perimeter between frame and exterior wall cladding /siding as shown.

Rigid Insulation Supplement for All Windows and Doors



For Both Drainage and Barrier Water Management

Read this document and the Important Safety and Product Information found at www.andersenwindows.com before starting.

for:

Shape - All

Construction Type - New Construction

Wall Type - Wood Stud - Rigid Insulation

Sill Flashing Method - 1 Piece (Flexible)

Weather Resistant Barrier - Pre-Window
Installation

- (A) House Wrap/Drainage Plane
- (B) Rigid Foam Insulation
- (C) Installation Flange
- (D) Structurally Fastened Support Piece
- (E) Full Depth Structural Support
(Full depth structural support can also be
used at head and sides if desired)
- (F) Window or Door

WARNING

Install the window or door into a structurally supported opening with the installation flanges/ nailing fin on the same plane as the drainage plane. Failure to do so could result in injury, product or property damage.

Typical Wall Representation

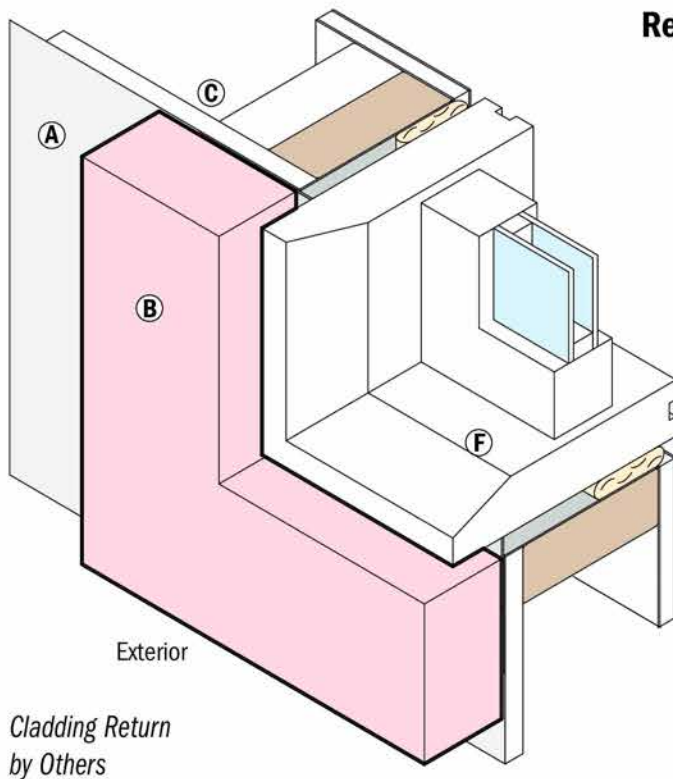

**Window or Door installed
BEFORE rigid insulation**

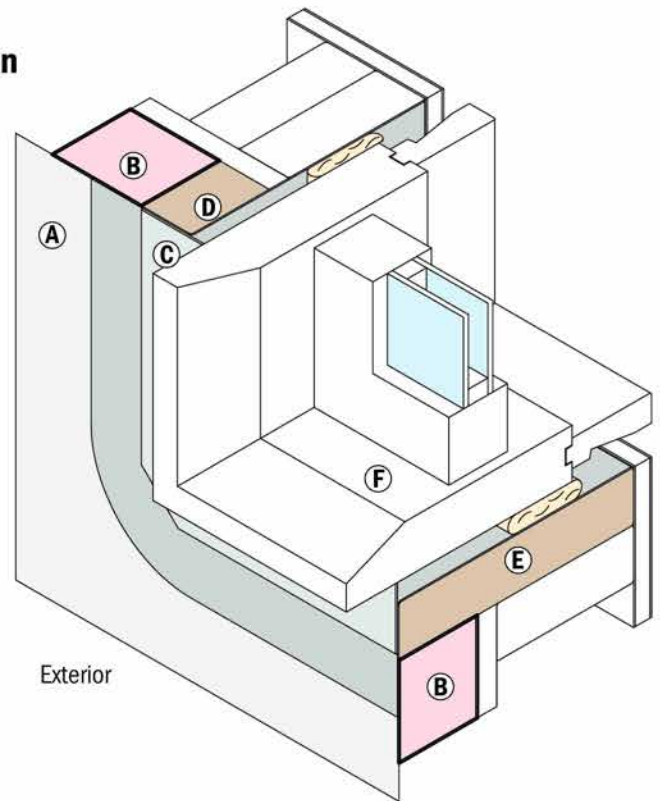

**Window or Door installed
AFTER rigid insulation**

Important information

- This installation detail shows the location of the drainage plane when a window or door is installed into an opening with rigid insulation. Read and follow the installation instructions for your window or door to install window or door into the opening.
- Read all Safety and Product Information.
- For installation instructions, removal instructions, and additional information go to: andersenwindows.com
- For questions call 1-888-888-7020.

Installation is complete.